

AD系列铝合金齿轮齿条式直线滑台



说明:

AD 系列是卓立汉光最新推出的燕尾副导轨手动直线滑台。该系列产品主体材料采用硬质铝合金，表面氧化黑处理，齿轮齿条驱动，燕尾副导轨导向，负载能力强，调整速度较快，且具有锁紧功能。

特点:

- 齿轮齿条驱动，可快速调整
- 燕尾副导轨导向，运行平稳，负载大

命名规则:

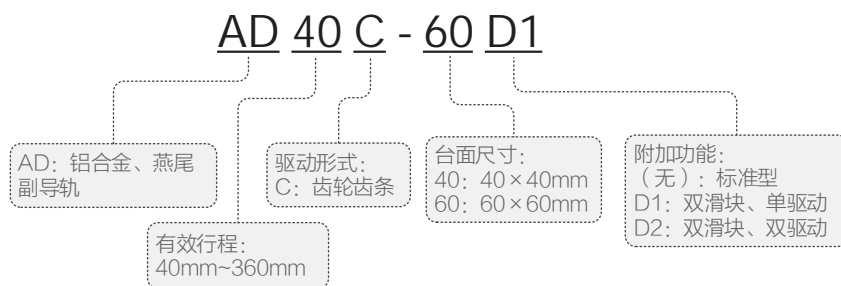

*此项为非标产品，需与销售代表确认增加滑块位置和货期； *增加滑块后移动量会受到影响； *附加功能不接受单独出货；

标准品	附加功能: D1	附加功能: D2	标准品	附加功能: D1	附加功能: D2
AD60C-40	×	×	AD40C-60	×	×
AD160C-40	●	●	AD140C-60	●	●
AD260C-40	●	●	AD240C-60	●	●
AD360C-40	●	●	AD340C-60	●	●

选型表

型号	AD60C-40	AD160C-40	AD260C-40	AD360C-40
台面尺寸 (mm)	40×40			
厚度 (mm)	30			
移动量 (°)	60	160	260	360
最小读数 (mm)	0.1			
驱动方式	正齿轮齿条 m=0.5			
导轨	燕尾副			
主体材料及表面处理	铝合金，黑色阳极氧化处理			
自重 (Kg)	0.25	0.4	0.55	0.7
中心负载 (Kg)	5			

型号	AD40C-60	AD140C-60	AD240C-60	AD340C-60
台面尺寸 (mm)	60×60			
厚度 (mm)	34			
移动量 (°)	40	140	240	340
最小读数 (mm)	0.1			
驱动方式	正齿轮齿条 m=0.5			
导轨	燕尾副			
主体材料及表面处理	铝合金，黑色阳极氧化处理			
自重 (Kg)	0.45	0.7	0.95	1.2
中心负载 (Kg)	6			

尺寸图:

AD60C-40

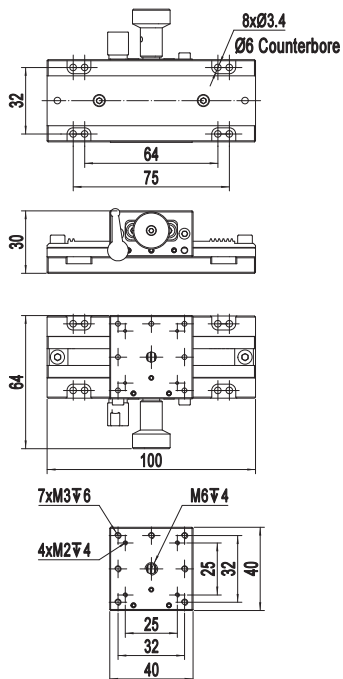
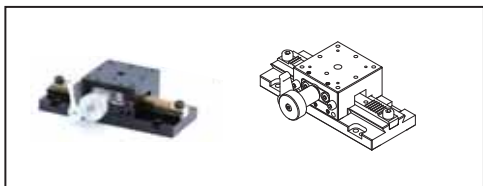

AD160C-40

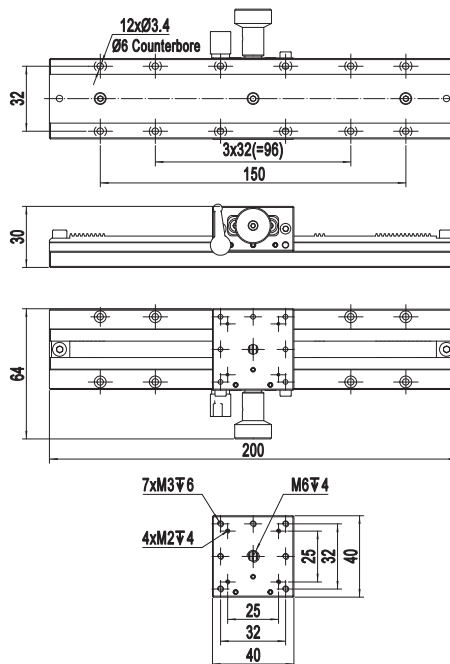
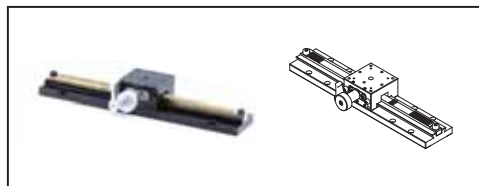

AD260C-40

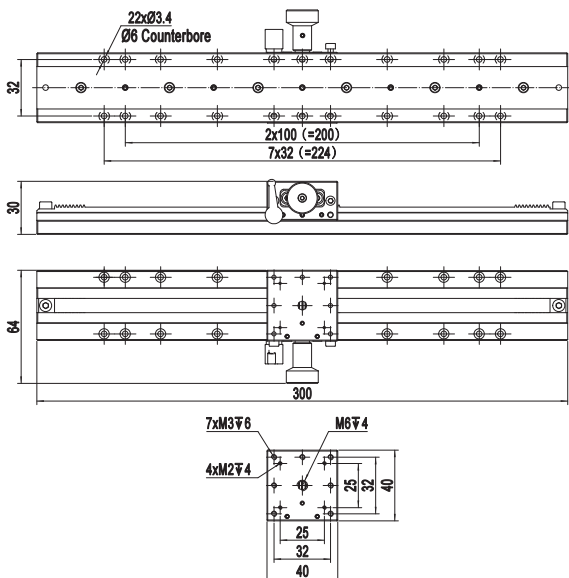
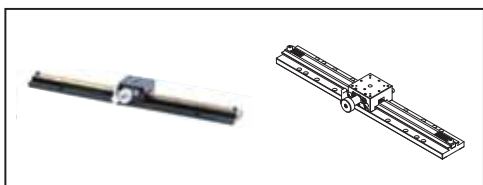

AD360C-40

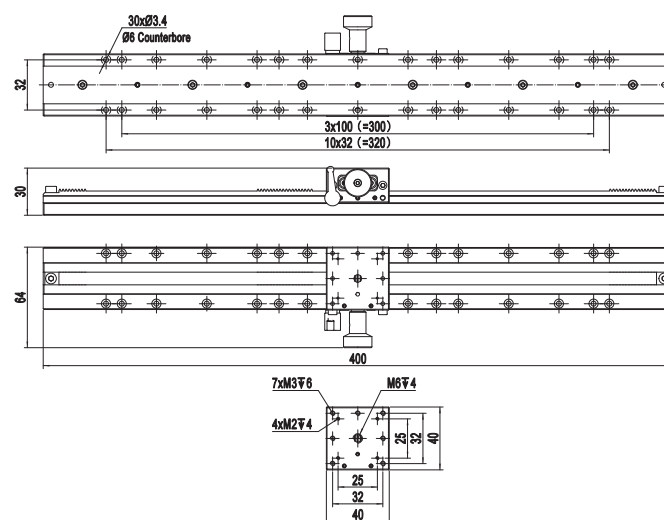
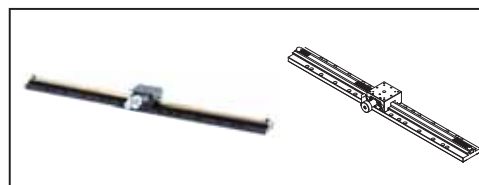

AD40C-60

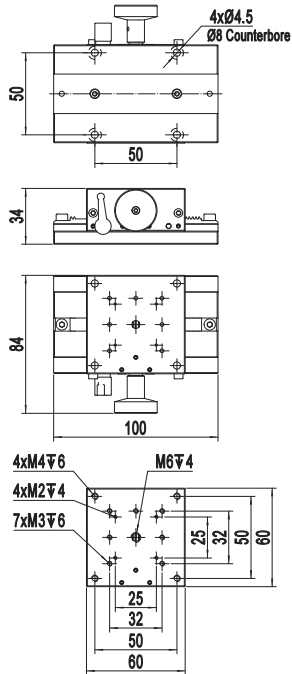
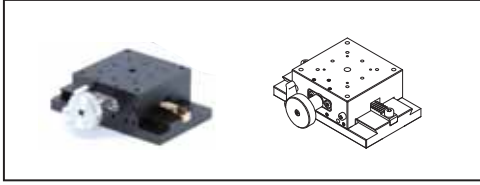

AD140C-60

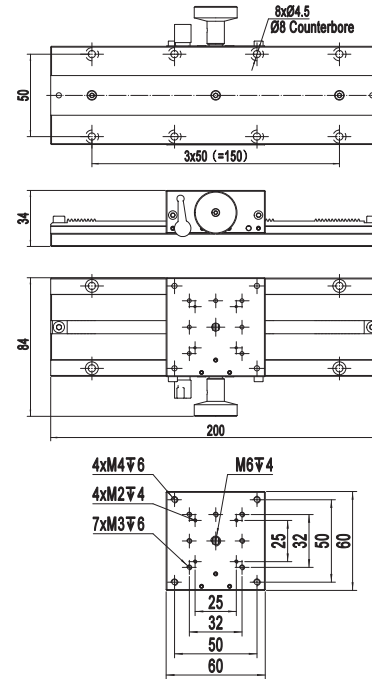
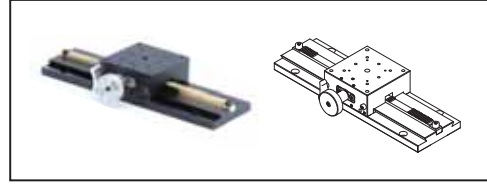

AD240C-60

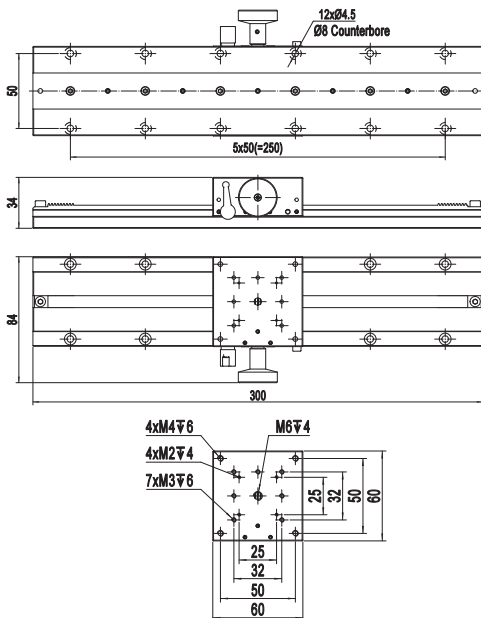
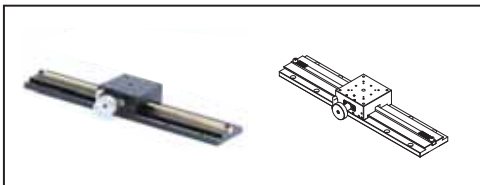

AD340C-60

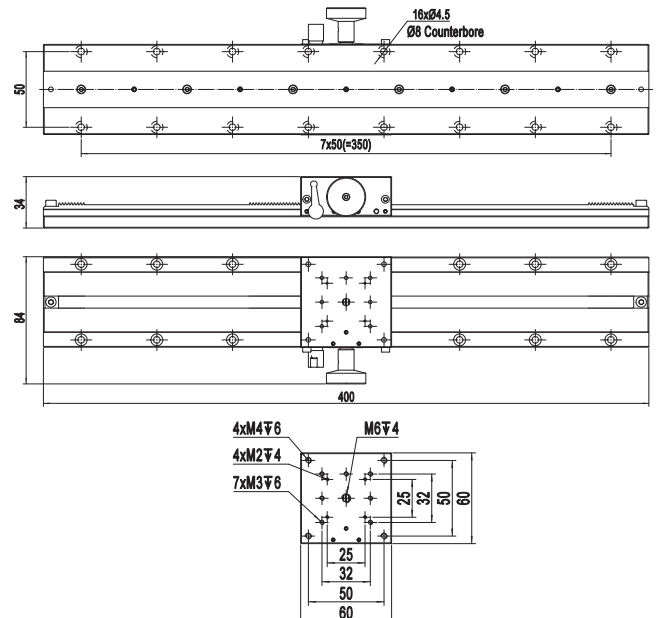
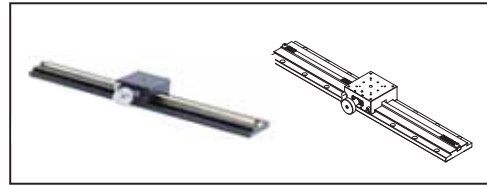

AD140C-60D1

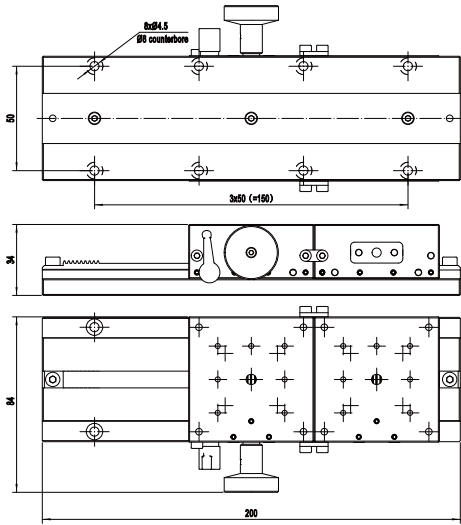
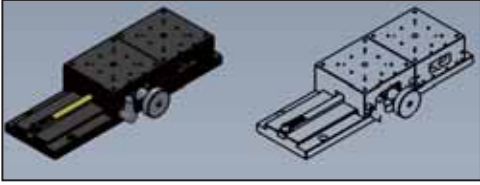

AD140C-60D2

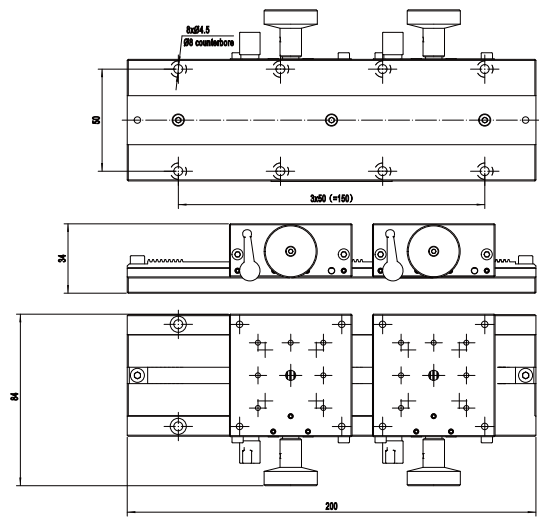
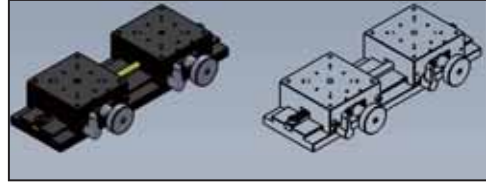

AD160C-40D1

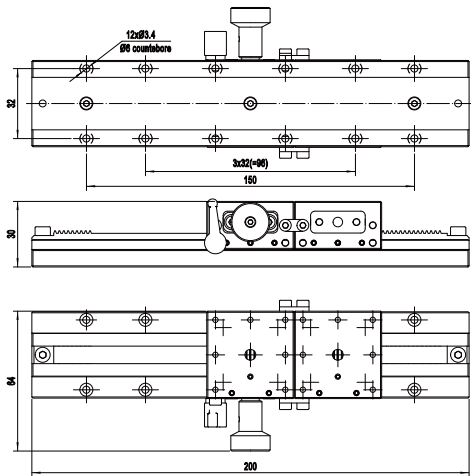
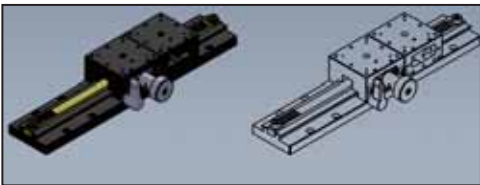

AD160C-40D2

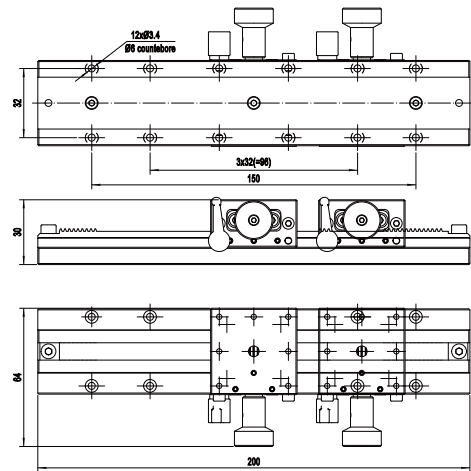
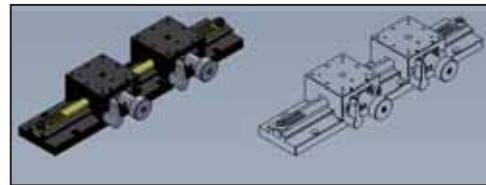

AD240C-60D1

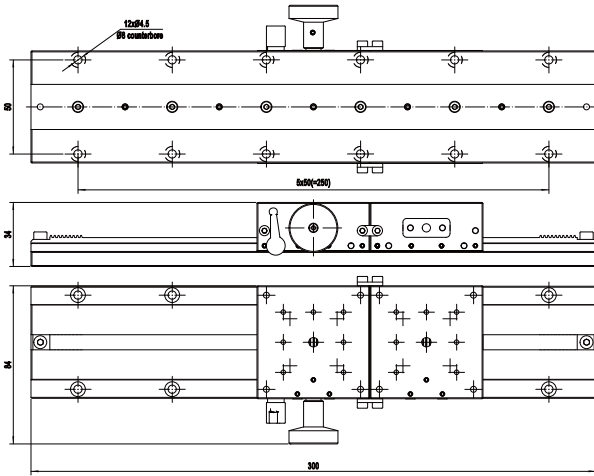
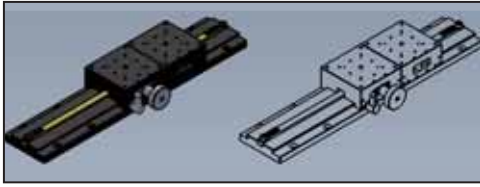

AD240C-60D2

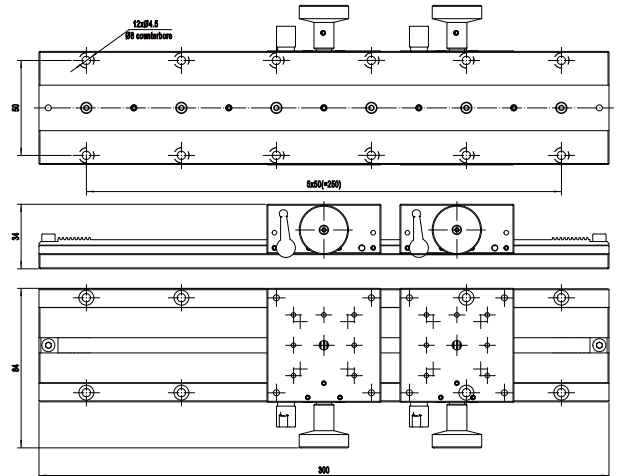
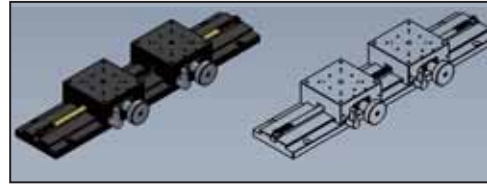

AD260C-40D1

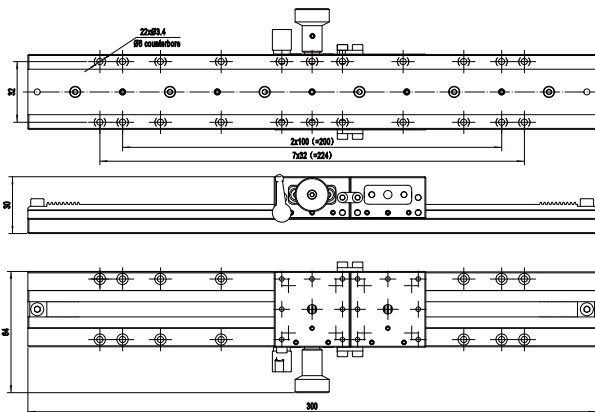
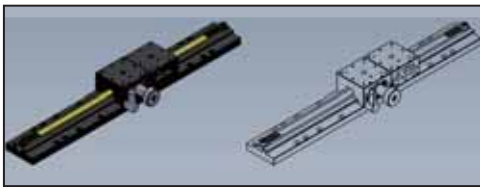

AD260C-40D2

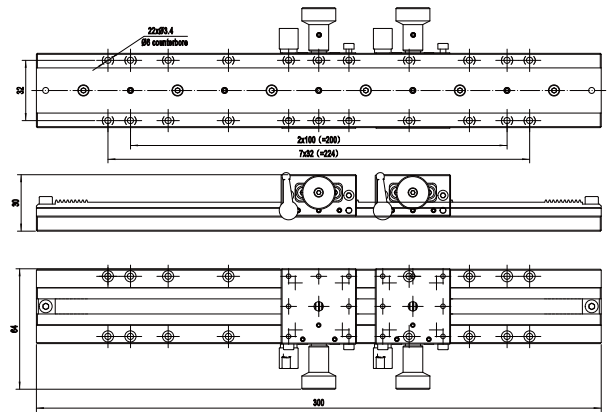
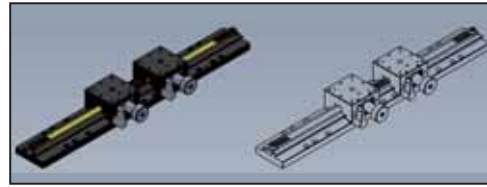

AD340C-60D1

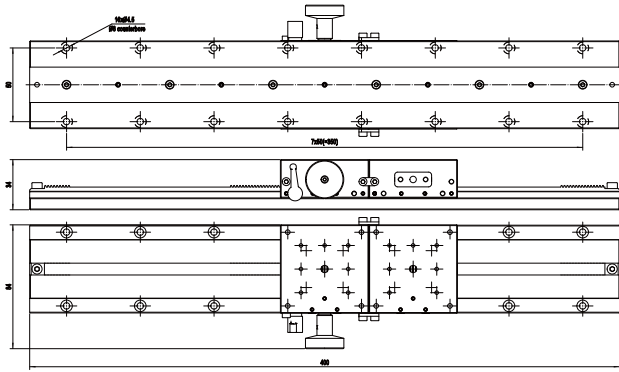
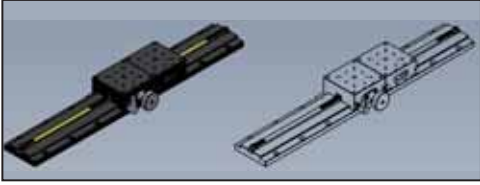

AD340C-60D2

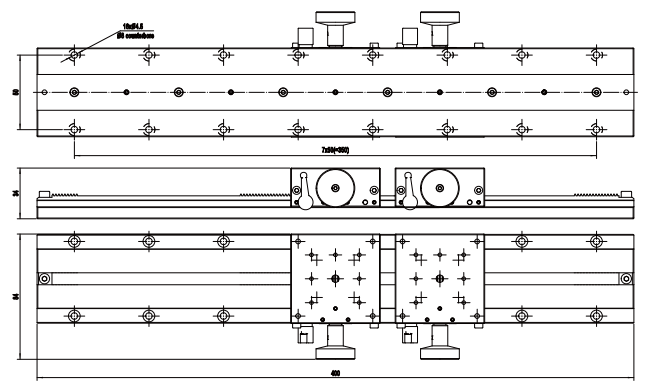
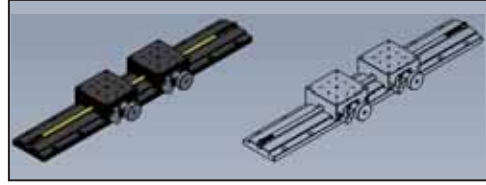

AD360C-40D1

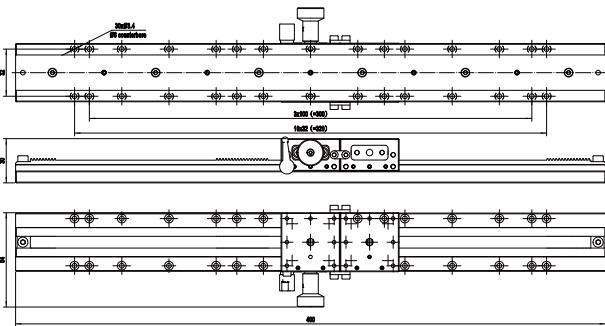
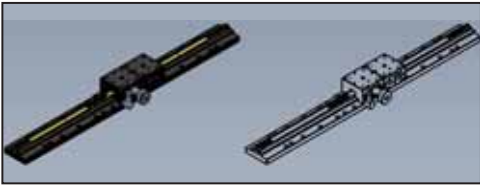

AD360C-40D2

